

**Part A**  
**Premise Licence under Licensing Act 2003**

**Premise Licence Number SDDC/001975**

**Part 1 – Premise Details**

Postal Address of premises, or if none Ordnance Survey map reference of description <b>Alma Inn 59 Derby Road Melbourne Derbyshire DE73 8FE</b>											
Telephone Number <b>01332 862411</b>											
Where the Licence is time limited the dates <b>Not Applicable</b>											
Licensable Activities authorised by the licence <b>Provision of regulated entertainment for; b) films, c) indoor sporting events, e) live music, f) recorded music, g) performances of dance</b> <b>Provision of entertainment facilities for l) making music and j) dancing</b> <b>Provision of late night refreshment</b> <b>Sale by retail of alcohol for consumption on and off the premises</b>											
The times the licence authorises the carrying out of licensable activities <b><u>For the supply of alcohol &amp; Late Night Refreshment (licensable after 23:00hrs)</u></b> <table> <tr> <td><b>Sunday to Thursday</b></td> <td><b>10.00hrs until 23.30hrs</b></td> </tr> <tr> <td><b>Friday &amp; Saturday</b></td> <td><b>10.00hrs until 00.30hrs</b></td> </tr> <tr> <td><b>Bank Holiday Sundays &amp; Mondays, }</b></td> <td></td> </tr> <tr> <td><b>Christmas Eve &amp; Boxing Day }</b></td> <td><b>10.00hrs until 00.30hrs</b></td> </tr> <tr> <td colspan="2"><b>New Year Period: 10:00hrs New Years Eve until terminal hour on New Year's Day</b></td> </tr> </table>		<b>Sunday to Thursday</b>	<b>10.00hrs until 23.30hrs</b>	<b>Friday &amp; Saturday</b>	<b>10.00hrs until 00.30hrs</b>	<b>Bank Holiday Sundays &amp; Mondays, }</b>		<b>Christmas Eve &amp; Boxing Day }</b>	<b>10.00hrs until 00.30hrs</b>	<b>New Year Period: 10:00hrs New Years Eve until terminal hour on New Year's Day</b>	
<b>Sunday to Thursday</b>	<b>10.00hrs until 23.30hrs</b>										
<b>Friday &amp; Saturday</b>	<b>10.00hrs until 00.30hrs</b>										
<b>Bank Holiday Sundays &amp; Mondays, }</b>											
<b>Christmas Eve &amp; Boxing Day }</b>	<b>10.00hrs until 00.30hrs</b>										
<b>New Year Period: 10:00hrs New Years Eve until terminal hour on New Year's Day</b>											
<b><u>In relation to licensable activities except the provision of late night refreshments and alcohol</u></b> <table> <tr> <td><b>Sunday – Thursday</b></td> <td><b>10.00hrs until 23.00hrs</b></td> </tr> <tr> <td><b>Friday &amp; Saturday</b></td> <td><b>10.00hrs until Midnight</b></td> </tr> <tr> <td><b>Bank Holiday Sundays &amp; Mondays, }</b></td> <td></td> </tr> <tr> <td><b>Christmas Eve &amp; Boxing Day }</b></td> <td><b>10.00hrs until Midnight</b></td> </tr> <tr> <td><b>New Year's Eve</b></td> <td><b>10.00hrs until 01.00hrs</b></td> </tr> </table>		<b>Sunday – Thursday</b>	<b>10.00hrs until 23.00hrs</b>	<b>Friday &amp; Saturday</b>	<b>10.00hrs until Midnight</b>	<b>Bank Holiday Sundays &amp; Mondays, }</b>		<b>Christmas Eve &amp; Boxing Day }</b>	<b>10.00hrs until Midnight</b>	<b>New Year's Eve</b>	<b>10.00hrs until 01.00hrs</b>
<b>Sunday – Thursday</b>	<b>10.00hrs until 23.00hrs</b>										
<b>Friday &amp; Saturday</b>	<b>10.00hrs until Midnight</b>										
<b>Bank Holiday Sundays &amp; Mondays, }</b>											
<b>Christmas Eve &amp; Boxing Day }</b>	<b>10.00hrs until Midnight</b>										
<b>New Year's Eve</b>	<b>10.00hrs until 01.00hrs</b>										
<b><u>Non specific sporting extensions</u></b> - Restricted to 12 occasions per year on 14 days written notice to the police and the licensing authority. The police shall have the right of veto on the grounds of contravention of one or more of the licensing objective, such a right of veto not to be unreasonable exercised											
The opening hours of the premises <b>30 minutes beyond the licensable activity for the supply of alcohol and late night refreshment each day.</b>											
Where the licence authorises supplies of alcohol whether there are on and or off supplies <b>On and off sales</b>											

Date Issued: 15/03/2006

Date Last Amended: 07/08/2012

## Part 2

Name, (registered) address, telephone number and e-mail (where relevant) of holder of premise licence <b>Marston's PLC, Marston's House, Wolverhampton, WV1 4JT</b>
Registered number of holder, for example company number, charity number (where applicable) <b>00031461</b>
Name address and telephone number of designated premise supervisor where the premises licence authorises the supply of alcohol <b>Paula Quinby, The New Inn, 273 Horninglow Road, Burton on Trent</b>
Personal licence number and Issuing Authority of personal licence held by designated premise supervisor where the premise authorises for the supply of alcohol <b>SDDC/002612 South Derbyshire District Council</b>

## Annex 1 - Mandatory Conditions

### Mandatory Conditions where licence authorises supply of alcohol

1. No supply of alcohol may be made under the premises licence -
  - (a) at a time when there is no designated premises supervisor in respect of the premises licence or
  - (b) at a time when the designated premises supervisor does not hold a personal licence or his personal licence is suspended.
2. Every supply of alcohol under the premises licence must be made or authorised by a person who holds a personal licence.
3. (1) The responsible person shall take all reasonable steps to ensure that staff on relevant premises do not carry out, arrange or participate in any irresponsible promotions in relation to the premises.  
  
(2) In this paragraph, an irresponsible promotion means any one or more of the following activities, or substantially similar activities, carried on for the purpose of encouraging the sale or supply of alcohol for consumption on the premises in a manner which carries a significant risk of leading or contributing to crime & disorder, prejudice to public safety, public nuisance, or harm to children.
  - (a) games or other activities which require or encourage, or are designed to require or encourage, individuals to –
    - (i) drink a quantity of alcohol within a time limit (other than to drink alcohol sold or supplied on the premises before the cessation of the period in which the responsible person is authorised to sell or supply alcohol), or
    - (ii) drink as much alcohol as possible (whether within a time limit or otherwise)
  - (b) provision of unlimited or unspecified quantities of alcohol free or for a fixed or discounted fee to the public or to a group defined by a particular characteristic (other than any promotion or discount available to an individual in respect of alcohol for consumption at a table meal, as defined in section 159 of the Act).

Date Issued: 15/03/2006

Date Last Amended: 07/08/2012

- (c) Provision of free or discounted alcohol or any other thing as a prize to encourage or reward the purchase and consumption of alcohol over a period of 24 hours or less;
  - (d) Provision of free or discounted alcohol in relation to the viewing on the premises of a sporting event, where that provision is dependent on-
    - (i) the outcome of a race, competition or other event or process, or
    - (ii) the likelihood of anything occurring or not occurring;
  - (e) selling or supplying alcohol in association with promotional posters or flyers on, or in the vicinity of, the premises which can be reasonably be considered to condone, encourage or glamorise anti-social behaviour or to refer to the effects of drunkenness in any favourable manner.
4. The responsible person shall ensure that no alcohol is dispensed directly by one person into the mouth of another (other than where that other person is unable to drink without assistance by reasonable disability)
5. The responsible person shall ensure that free tap water is provided on request to customers where it is reasonably available.
6. a. The premise licence holder or club premises certificate holder shall ensure that an age verification policy applies to the premise in relation to the sale or supply of alcohol.
- b. The policy must require individuals who appear to the responsible person to be under 18 years of age (or such older age as may be specified in the policy) to produce on request, before being served alcohol, identification bearing their photograph, date of birth and a holographic mark (1<sup>st</sup> October 2010).
7. The responsible person shall ensure that-
- a. where any of the following alcoholic drinks sold or supplied for consumption on the premises (other than alcoholic drinks sold or supplied having been made up in advance ready for sale or supply in a securely closed container) it is available to customers in the following measures-
- (1) beer or cider: ½ pint;
  - (2) gin, rum, vodka or whisky: 25ml or 35 ml; and
  - (3) still wine in a glass: 125 ml; and
- b. customers are made aware of the availability of these measures. (1<sup>st</sup> October 2010).

## **Mandatory Condition -Exhibition of Films**

1. Where a premise licence authorises the exhibition of films, then the admission of children to the exhibition should be restricted in accordance with this section.

2. Where the film classification body is specified in the licence, unless subsection (3)(b) applies, admission of children must be restricted in accordance with any recommendation made by that body.

3. Where:-

(a) the film classification body is not specified in the licence,  
or

(b) the relevant licensing authority has notified the holder of the licence that this subsection applies to the film in question, admission of children must be restricted in accordance with any recommendation made by the licensing authority.

4. Children is defined as persons aged under 18; and film classification body means the person or persons designated as the authority under Section 4 of the Video Recordings Act 1984 (C.39)(authority to determine suitability of video works for classification)

## **Annex 2 - Conditions consistent with Operating Schedule**

### **The Prevention of crime and disorder**

- Persons employed in a security activity shall be licensed by the Security Industry Authority and will be employed at the discretion of the designated premise supervisor or the premise licence holder and will display a name badge at all times whilst on duty
- No customers apparently carrying open bottles upon entry shall be admitted to the premises at any time the premises are open to the public
- Where CCTV is installed with recording facilities, such recordings shall be retained for a period of 30 days and made available within a reasonable time upon request by the police
- Alcoholic and other drinks may not be removed from the premises in open containers save for consumption in any external area provided for that purpose

### **Public Safety**

- To comply with the reasonable requirements of the fire officer and building control officer as appropriate

Date Issued: 15/03/2006

Date Last Amended: 07/08/2012

### The prevention of public nuisance

- Noise and vibration shall not emanate from the premises so as to cause a nuisance to nearby properties
- Where appropriate, prominent, clear and legible notices shall be displayed at all exits, requesting the public respect the needs of local residents and to leave the premises and area quietly
- The licensee shall ensure that all windows and doors are kept closed for the duration of live and recorded music and other entertainment, except for access and egress from that room
- The licensee shall install a noise limiting cut out device at a decibel rating determined by South Derbyshire District Council's Environmental Health Department
- The licensee shall ensure that no alcohol is consumed outside of the premises after the hours of 22.30hrs

### **Annex 3 - Conditions attached after a hearing by the licensing authority**

In relation to the Opening Hours these were to be as follows: (Standard times)

- Sunday to Thursday : 10.00am until 12.00am (midnight);
- Friday and Saturday : 10.00am until 1.00am;
- (Non Standard times)
- Bank Holidays; Sunday and Monday; 10.00am until 1.00am;
- Christmas Eve : 10.00am until 1.00am;
- Boxing Day : 10.00am until 1.00am;
- New Years Eve : 10.00am to terminal hour on New Years Day

\*\*\*\*\*

In relation to the Supply of Alcohol these hours were to be as follows:  
(Standard times)

- Sunday to Thursday : 10.00am until 11.30pm
- Friday and Saturday : 10.00am until 12.30am
- (Non Standard times)
- Bank Holidays; Sunday and Monday ; 10.00am until 12.30am
- Christmas Eve : 10.00am until 12.30am
- Boxing Day : 10.00am until 12.30am
- New Years Eve : 10.00am to terminal hour on New Years Day
- All times with an additional 30 minutes drinking up time

\*\*\*\*\*

In relation to Live Music these hours were to be as follows: (Standard times)

- Sunday to Thursday : 10.00am until 11.00pm;
- Friday and Saturday : 10.00am until 12.00am (midnight);
- (Non Standard times)
- Bank Holidays; Sunday and Monday ; 10.00am until 12.00am (midnight);
- Christmas Eve : 10.00am until 12.00am (midnight);
- Boxing Day : 10.00am until 12.00am (midnight);
- New Years Eve : 10.00am until 1.00am;

\*\*\*\*\*

In relation to Recorded Music these hours were to be as follows:(Standard times)

- Sunday to Thursday : 10.00am until 11.00pm;
- Friday and Saturday : 10.00am until 12.00am (midnight);
- (Non Standard times)
- Bank Holidays; Sunday and Monday ; 10.00am until 12.00am (midnight);
- Christmas Eve : 10.00am until 12.00am (midnight);
- Boxing Day : 10.00am until 12.00am (midnight);
- New Years Eve : 10.00am until 1.00am;

\*\*\*\*\*

In relation to the Late Night Refreshment these hours were to be as follows:  
(Standard times)

- Sunday to Thursday : 10.00am until 11.30pm;
- Friday and Saturday : 10.00am until 12.30am;
- (Non Standard times)
- Bank Holidays; Sunday and Monday ; 10.00am until 12.30am;
- Christmas Eve : 10.00am until 12.30am;
- Boxing Day : 10.00am until 12.30am;
- New Years Eve: 10.00am to terminal hour New Years Day

In relation to Performances of Dance these hours were to be as follows:  
(Standard times)

- Sunday to Thursday : 10.00am until 11.00pm;
- Friday and Saturday : 10.00am until 12.00am (midnight);
- (Non Standard times)
- Bank Holidays; Sunday and Monday ; 10.00am until 12.00am (midnight);
- Christmas Eve : 10.00am until 12.00am (midnight);
- Boxing Day : 10.00am until 12.00am (midnight);
- New Years Eve : 10.00am until 1.00am;

\*\*\*\*\*

In relation to Facilities for Making Music these hours were to be as follows:  
(Standard times)

- Sunday to Thursday : 10.00am until 11.00pm;
- Friday and Saturday : 10.00am until 12.00am (midnight);
- (Non Standard times)
- Bank Holidays; Sunday and Monday ; 10.00am until 12.00am (midnight);
- Christmas Eve : 10.00am until 12.00am (midnight);
- Boxing Day : 10.00am until 12.00am (midnight);
- New Years Eve : 10.00am until 1.00am;

\*\*\*\*\*

Date Issued: 15/03/2006

Date Last Amended: 07/08/2012

In relation to Facilities for Dancing these hours were to be as follows:

(Standard times)

- Sunday to Thursday : 10.00am until 11.00pm;
- Friday and Saturday : 10.00am until 12.00am (midnight);
- (Non Standard times)
- Bank Holidays; Sunday and Monday ; 10.00am until 12.00am (midnight);
- Christmas Eve : 10.00am until 12.00am (midnight);
- Boxing Day : 10.00am until 12.00am (midnight);
- New Years Eve : 10.00am until 1.00am;

\*\*\*\*\*

In relation to Indoor Sporting Events these hours were to be as follows:

(Standard times)

- Sunday to Thursday : 10.00am until 11.00pm;
- Friday and Saturday : 10.00am until 12.00am (midnight);
- (Non Standard times)
- Bank Holidays; Sunday and Monday ; 10.00am until 12.00am (midnight);
- Christmas Eve : 10.00am until 12.00am (midnight);
- Boxing Day : 10.00am until 12.00am (midnight);
- New Years Eve : 10.00am until 1.00am;

\*\*\*\*\*

In relation to Films these hours were to be as follows: (Standard times)

- Sunday to Thursday : 10.00am until 11.00pm;
- Friday and Saturday : 10.00am until 12.00am (midnight);
- (Non Standard times)
- Bank Holidays; Sunday and Monday ; 10.00am until 12.00am (midnight);
- Christmas Eve : 10.00am until 12.00am (midnight);
- Boxing Day : 10.00am until 12.00am (midnight);
- New Years Eve : 10.00am until 1.00am;

Variations are subject to the following conditions:

- The licensee shall ensure that prominent signage is displayed at all exit doors requesting customers to leave the area quietly and to respect neighbouring residents and their properties. In addition, there shall be prominent signage placed at the exit points from the premises' car park
- The licensee shall ensure that all windows and doors are kept closed for the duration of live and recorded music and other entertainment, except for access to and egress from that room. This condition is subject to the Licensee erecting signs in the premises informing customers of the necessity and reason for windows and doors to remain shut during such performances of live and recorded music and other entertainment
- A Noise Limiting device shall be installed, fitted and maintained by the Licensee in such manner as to control all sources of amplified music at the premises in order to ensure that music will be at a reasonable level at the nearest noise sensitive point as determined by the Environmental Health Department

Date Issued: 15/03/2006

Date Last Amended: 07/08/2012

- The licensee shall ensure that no alcohol is consumed outside of the premises after the hours of 22.30hrs
- The licensee shall ensure that non specific sporting extensions shall be restricted to 12 occasions per year on 14 days written notice to the Police, and the Police shall have right of veto on the grounds of contravention of one or more of the licensing objective, such a right of veto not to be unreasonably exercised.

**For clarification the conditions attaching to the Premises Licence can only apply to the Licensee in relation to the Alma Inn and the curtilage of the Alma Inn, which includes the car park, any beer garden and other external area.**



## Annex 4 - Plans



GROUND FLOOR PLAN

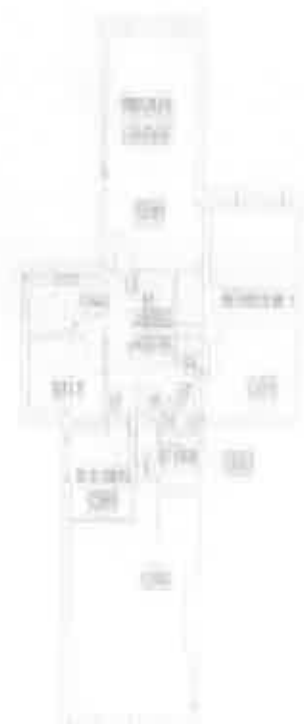

FIRST FLOOR PLAN

