

IMPORTANT - THIS COMMUNICATION AFFECTS YOUR PROPERTY

SOUTH DERBYSHIRE DISTRICT COUNCIL

TOWN AND COUNTRY PLANNING ACT 1990 - SECTION 215

RECORDED DELIVERY

To: Mr. P. Warrington,

Of: 29 Main Street, Hemington, Derby DE74 2RB

1. THIS NOTICE is served by the Council because it appears to them that the condition of land in their area adversely affects the amenity of part of their area or an adjoining area.

It has been served upon you as the person who appears to be the owner of the land.

2. THE LAND

Land and buildings being approximately 500 square metres in area and situated opposite Railway Cottages, Findern Lane, Stenson, Derby as shown edged red on the attached plan.

3. WHAT YOU ARE REQUIRED TO DO

In exercise of their powers under Section 215 the Council requires you to:-

1. Remove permanently from the site the two vans situated on the road frontage of the land.
2. Remove permanently from the land the damaged ambulance and touring caravan situated within the fenced area.
3. Remove the dilapidated garage and wooden structure from the land together with their contents.
4. Remove from the land all scrap timber and other building materials resulting from compliance with Step 3 above.
5. Remove the scrap motor tyres and other items of waste material from the land.
6. Maintain the land in a tidy condition.

4. TIME FOR COMPLIANCE

28 days after this Notice takes effect.

5. WHEN THIS NOTICE TAKES EFFECT LIMITS

This Notice takes effect on 17th May 2004 unless an appeal is made against it before hand.

6. YOUR RIGHT OF APPEAL

You can appeal against this Notice but any appeal must be received by the Magistrates Court before the date specified in paragraph 5 of the Notice.

7. WHAT HAPPENS IF YOU DO NOT APPEAL

It is an offence to fail to take the steps required to comply with this Notice. The maximum penalty on conviction is a fine of £1,000. Continuing failure to comply following a conviction will constitute a further offence the penalty for which is a maximum fine of £100 for each day following the first conviction during which the requirements of this Notice are not met.

8. LAW

A copy of the relevant provisions of the Act are attached to this Notice.

DATED the 14th day of May 2004



A. P. Sylvester
Development Control Manager

South Derbyshire District Council,
Civic Offices,
Civic Way,
Swadlincote,
Derbyshire, DE11 0AH.

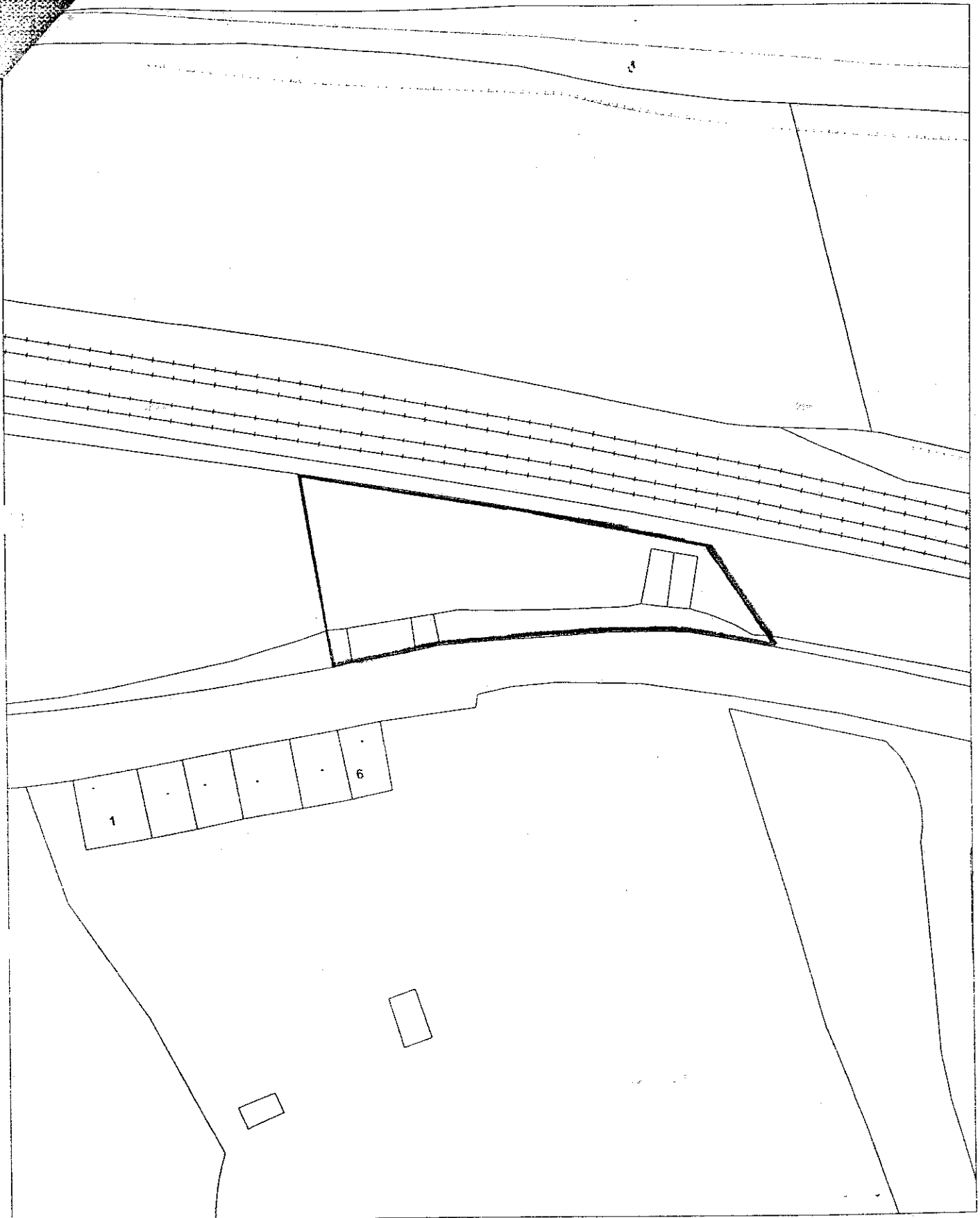

**South Derbyshire
 District Council
 Civic Offices
 Civic Way
 Swadlincote
 DE11 0AH**

**Land and buildings opposite Railway Cottages
 Findern Lane
 Stenson
 Derby**

Date Plotted 12/5/2004

NORTH ↑

Plot centred at 432317 329949

Scale 1:500

Based upon the Ordnance Survey mapping with the permission of the controller
 of Her Majesty's Stationary Office. (c) Crown Copyright. Unauthorised reproduction
 infringes Crown Copyright and may lead to prosecution or civil proceedings.

License No LA 079375

